



Slate Upper School

Town of North Haven Planning & Zoning Commission

May 18, 2021

Slate Upper School
5100 Ridge Road, North Haven



Density Mapping: Students per Acre

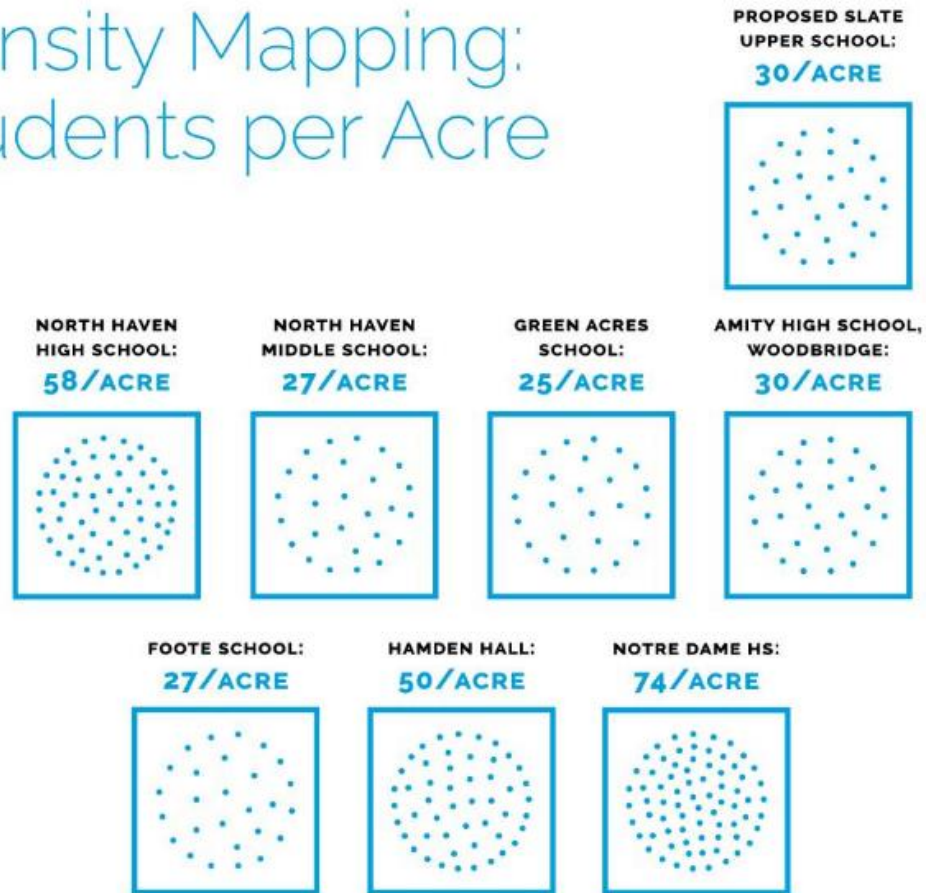

Density Mapping: Students per Acre, *Excluding Athletic Fields*

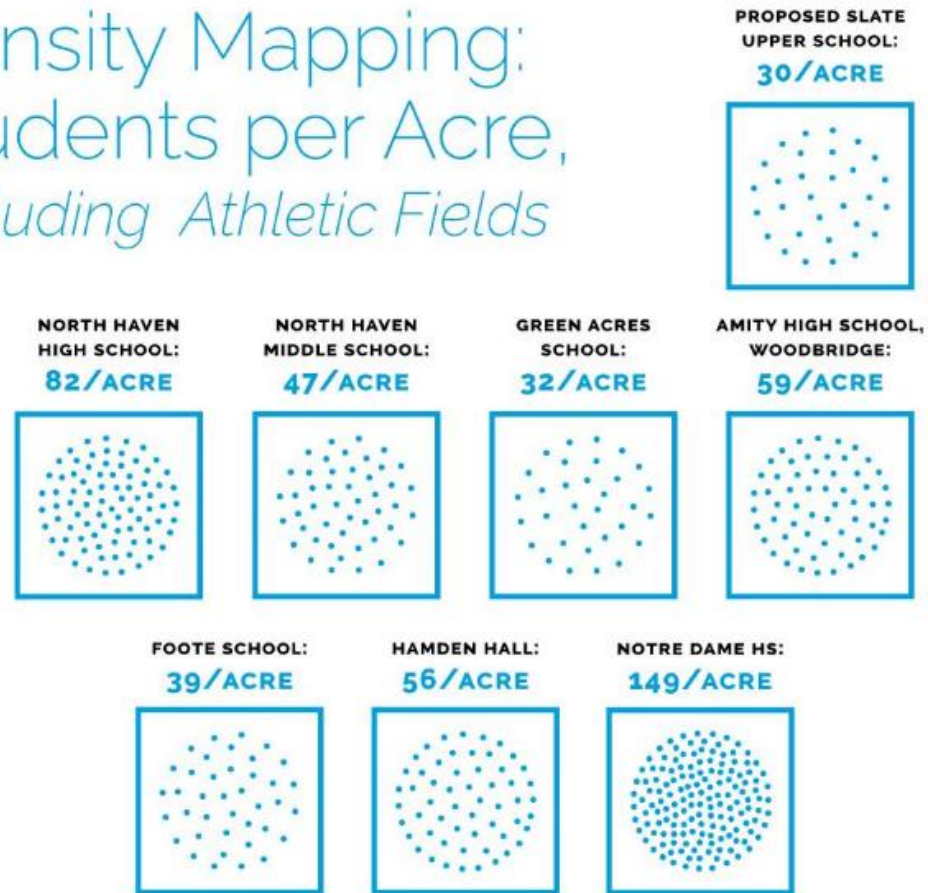

LIGHTING LEGEND		
	POLE MOUNTED LIGHTING	3
	BALLAST LIGHT	12
	LANDSCAPE LIGHTING	10
	STEP LIGHTS IN WALL	22
	INGROUND BREAK ITS	3
	INGROUND BREAK ITS (IN TECHNICAL AREA ONLY)	4
	INGROUND FLUSH POWER LIGHTS	12



Previous Layout



Revised Layout

LIGHTING LEGEND		
	POLE MOUNTED LIGHTING	8
	BALLAST LIGHT	11
	STEP LIGHTS IN WALL	12
	INGROUND BREAK ITS	2
	HANDRAIL LIGHTING	6
	BUILDING MOUNTED LIGHTING	5
	WALL MOUNTED LIGHTING	9

Overall reduction in number of site lights.

Controls Narrative

- Exterior lights turn on at dusk via photocell.
- Exterior lights turn off at a set time in the evening via timeclock.
- Exterior lights turn on at dawn via timeclock, and shut off via photocell.
- Over-ride ability for special events, reset by time clock so lights shut off overnight.
- *No motion sensors.*

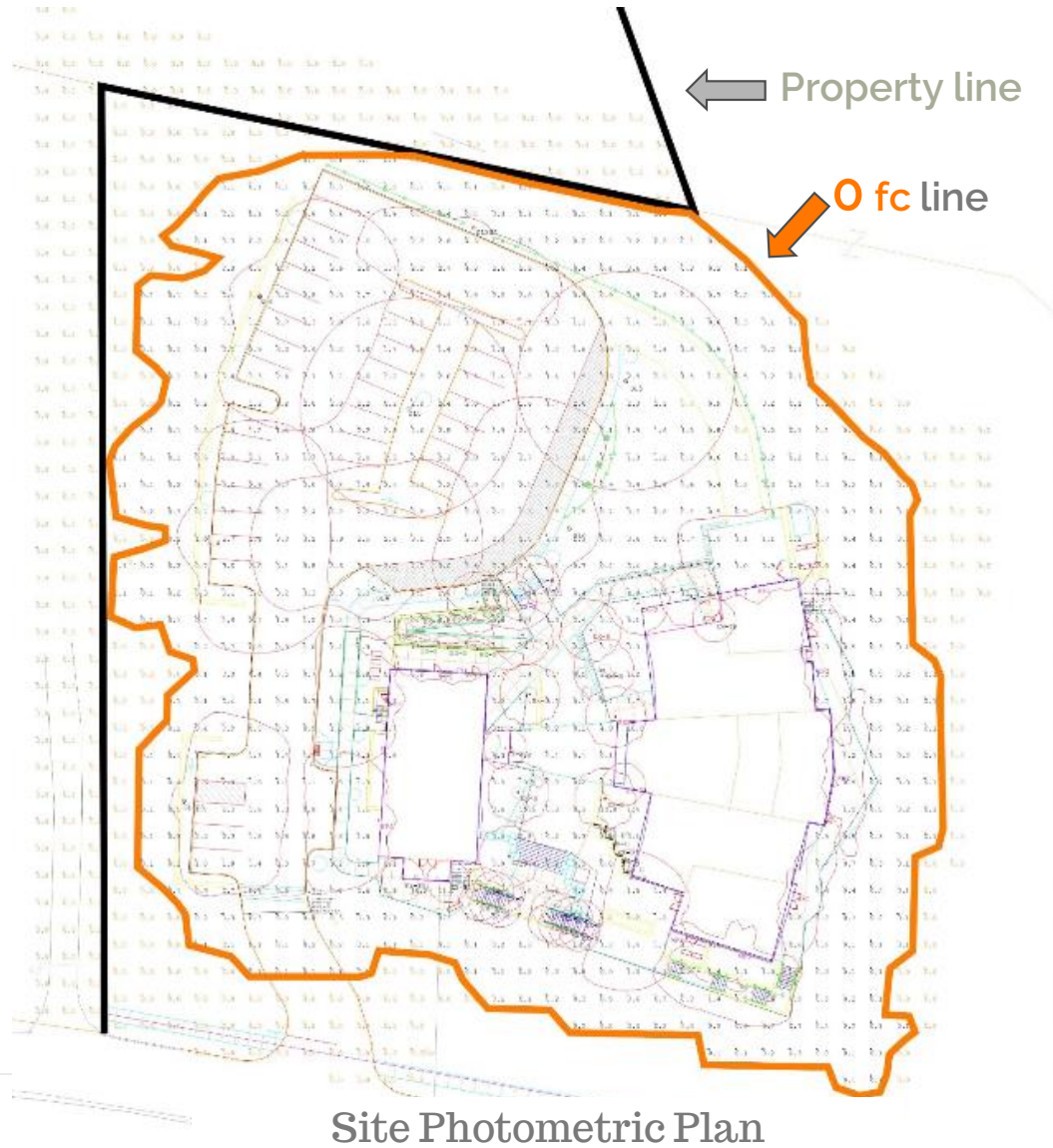

All fixtures are 3K LED +
Dark Sky Compliant







Location 1:
5200 Ridge Road
"Before" - Early Spring

Slate Upper School
5100 Ridge Road, North Haven

View Shed Study

SLR  PATRIQUIN
ARCHITECTS



Location 1:
5200 Ridge Road
"After"



Location 2:
5060 Ridge Road
"Before"



Location 2:
5060 Ridge Road
"After"

Slate Upper School
5100 Ridge Road, North Haven

View Shed Study

SLR  PATRIQUIN
ARCHITECTS



Thank you.

Slate Upper School
5100 Ridge Road, North Haven

SLR  PATRIQUIN
ARCHITECTS